

**W-series terminal with clamping yoke connection  
WDU 10**

Weidmüller Interface GmbH & Co. KG  
Klingenbergstraße 16  
D-32758 Detmold  
Germany  
Fon: +49 5231 14-0  
Fax: +49 5231 14-2083  
www.weidmueller.com

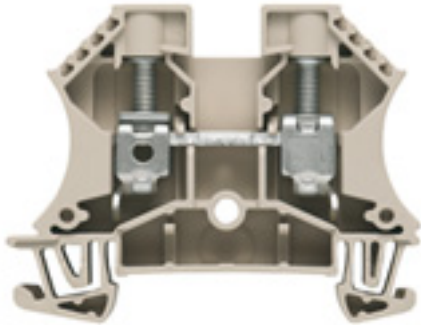

The versatile and extensive range of products - from 0.05 mm<sup>2</sup> to 300 mm<sup>2</sup> - means that you have diverse options for your applications at your disposal.

Hardened steel for mechanical strength and high-quality tinned copper for optimum conductivity. All materials comply with RoHS requirements and have been tested to current environment guidelines.

**General ordering data**

Order No.	<a href="#">1020300000</a>
Type	WDU 10
Version	W-series terminal with clamping yoke connection, Feed-through terminal, Rated cross-section: 10 mm <sup>2</sup> , Screw connection, Direct mounting
GTIN (EAN)	4008190068868
Qty.	50 pc(s).

**W-series terminal with clamping yoke connection  
WDU 10**

**Weidmüller Interface GmbH & Co. KG**  
Klingenbergstraße 16  
D-32758 Detmold  
Germany  
Fon: +49 5231 14-0  
Fax: +49 5231 14-2083  
www.weidmueller.com

**Technical data**

**Dimensions**

Length	60 mm	Width	9.9 mm
Height	46.5 mm	Height of lowest version	47 mm
Weight	18.46 g		

**Temperatures**

Operating temperature	Storage temperature
-----------------------	---------------------

**Rated data IECEx/ATEX**

Certificate No. (ATEX)	KEMA98ATEX1683U	ATEX certificate	KEMA98ATEX1683U_d.pdf
ATEX certificate	KEMA98ATEX1683U_e.pdf	IEC Ex certificate	IECExULD05.0008U_e.pdf
max. voltage	690 V	Current (ATEX)	50 A
Wire cross section max. (ATEX)	10 mm <sup>2</sup>	Voltage, cross-connection	CrossConnectionGuide.pdf
Operating temperature range	For operating temperature range see EC Design Test Certificate / IEC Ex-Certificate of Conformity	Marking EN 60079-7	
Marking ATEX Directive 94/9/EC	II 2 G D		Ex e II

**2 clampable wires (H05V/H07V) same cross-section (rated connection)**

Cross-section for connected wire, stranded, two clampable wires, min.	0.5 mm <sup>2</sup>	Cross-section for connected wire, stranded, two clampable wires, max.	6 mm <sup>2</sup>
Wire connection cross section, finely stranded, two clampable wires, min.	0.5 mm <sup>2</sup>	Wire cross-section, finely stranded, two clampable wires, max.	6 mm <sup>2</sup>
Wire connection cross section, finely stranded with wire-end ferrules DIN 46228/1, 2 clampable wires, min.	0.5 mm <sup>2</sup>	Wire connection cross section, finely stranded with wire-end ferrules DIN 46228/1, 2 clampable wires, max.	6 mm <sup>2</sup>

**Additional technical data**

Explosion-tested version	Yes	Installation advice	Direct mounting
Number of similar terminals	1	Open sides	right
Type of mounting	Snap-on	Version	Double terminal

**CSA ratings data**

Certificate No. (CSA)	200039-1057876	Voltage size C (CSA)	600 V
Current size C (CSA)	65 A	Wire cross section max. (CSA)	6 AWG
Wire cross section min. (CSA)	18 AWG		

**W-series terminal with clamping yoke connection  
WDU 10**

Weidmüller Interface GmbH & Co. KG  
Klingenbergstraße 16  
D-32758 Detmold  
Germany  
Fon: +49 5231 14-0  
Fax: +49 5231 14-2083  
www.weidmueller.com

**Technical data**

**Clampable wires (rated connection)**

Type of connection	Screw connection	Stripping length	12 mm
Blade size	1.0 x 5.5 mm	Connection direction	on side
Number of connections	2	Clamping range, rated connection, min.	1.31 mm <sup>2</sup>
Clamping range, rated connection, max.	16 mm <sup>2</sup>	Clamping screw	M 4
Tightening torque, min.	1.5 Nm	Tightening torque, max.	2.4 Nm
Torque level with DMS electric screwdriver	4	Gauge to IEC 60947-1	B6
Wire connection cross section, solid core, max. rated connection	1.5 mm <sup>2</sup>	Wire connection cross section, solid core max. rated connection	16 mm <sup>2</sup>
Wire connection cross section, stranded, rated connection, min.	1.5 mm <sup>2</sup>	Wire connection cross section, stranded, rated connection, max.	16 mm <sup>2</sup>
Wire connection cross section, finely stranded, max.	16 mm <sup>2</sup>	Wire connection cross-section, finely stranded, min.	1.5 mm <sup>2</sup>
Wire connection cross section, finely stranded with wire-end ferrules DIN 46228/1, rated connection, min.	1.5 mm <sup>2</sup>	Wire connection cross section, finely stranded with wire-end ferrules DIN 46228/1, rated connection, max.	16 mm <sup>2</sup>
Cross-section for connected conductor, finely stranded with wire-end ferrules and plastic collars DIN 46228/4, rated connection, min.	1.5 mm <sup>2</sup>	Wire connection cross-section, finely stranded with wire-end ferrules and plastic collars DIN 46228/4, rated connection, max.	16 mm <sup>2</sup>
Twin wire-end ferrules, min.	1.5 mm <sup>2</sup>	Twin wire-end ferrules, max.	6 mm <sup>2</sup>
Wire connection cross section AWG, min.	AWG 16	Wire connection cross section AWG, max.	AWG 6

**Rated data**

Rated cross-section	10 mm <sup>2</sup>	Rated voltage	1,000 V
Rated impulse withstand voltage	8 kV	Rated current	57 A
Current at maximum wires	76 A	Standards	IEC 60947-7-1
Pollution severity	3		

**UL ratings data**

Certificate No. (UR)	E60693VOL1SEC38	Voltage size C (UR)	600 V
Current size C (UR)	65 A	Conductor size Factory wiring max. (UR)	6 AWG
Conductor size Factory wiring min. (UR)	18 AWG	Conductor size Field wiring max. (UR)	6 AWG

**Material data**

Material	Wemid	Colour	beige
Flammability class UL 94	V-0		

**System specifications**

Product family	W-series terminal with clamping yoke connection	Type of connection	Screw connection
Connection direction	on side	Number of levels	1
Number of connections	2	No. of clamping points per level	2
Levels cross-connected internally	No	Mounting rail	TS 35
End cover plate required	No		

**Classifications**

ETIM 2.0	EC000897	ETIM 3.0	EC000897
ETIM 4.0	EC000897	UNSPSC	30-21-18-11
eClass 4.1	27-14-11-20	eClass 5.1	27-14-11-20
eClass 6.0	27-14-11-20		

**W-series terminal with clamping yoke connection  
WDU 10**

Weidmüller Interface GmbH & Co. KG  
Klingenbergstraße 16  
D-32758 Detmold  
Germany  
Fon: +49 5231 14-0  
Fax: +49 5231 14-2083  
www.weidmueller.com

**Technical data****Approvals**

Approvals	BURVER; CE; CSA; CSAEX; CURUSEX; DETNORVER; GERMLLOYD; GOSTEX; GOSTME25; IECEXULD; KEMAATEX; KEMAKEUR; LLOYDSREG; MARITREG; NEMKO; UR; ROHS
-----------	---

**Product information**

Note, ordering data	For colours available see section W-series accessories "Specific functions"
Note, technical data	Note max. current of terminal (76 A) when using WQV! AWG 6/7 and H07V-R16 tightened with 2.4 Nm.
Note, accessories	Socket and test plug refer to W-series Accessories section Only 400 V when using the shielding rail LS 2,8 1056400000.

**Downloads**

DXF	<a href="#">09255_WDU_10_DXF.dxf</a>
STEP	<a href="#">1020300000_09255_WDU_10_GN_WAP_GE_STP.stp</a>
<a href="#">3D model</a>	

**Datasheet**

**W-series terminal with clamping yoke connection  
WDU 10**

Weidmüller Interface GmbH & Co. KG  
Klingenbergstraße 16  
D-32758 Detmold  
Germany  
Fon: +49 5231 14-0  
Fax: +49 5231 14-2083  
[www.weidmueller.com](http://www.weidmueller.com)

**Drawings**

